



TILLER EXTENSIONS

Used by sailors in the world's most competitive classes, the Ronstan Battlestick™ delivers performance, precise control and a secure grip.

Battlesticks™ are manufactured from black anodised Aluminium alloy tubing for maximum strength, light weight and positive helm response. Fixed length versions use a fluted tubular section for increased rigidity, in either Lightweight 16mm (5/8") or Jumbo 25mm (1") diameter.

Hyperlon® grips offer a firm, non slip gripping area that does not absorb water.

Ladder tiller extensions are ideal for small keelboats. The three gripping positions

eliminate the need for a telescopic extension. The handle section is fitted with a swivel head system, free to rotate for comfortable control when tacking and gybing.

The Carbon Fibre Battlestick™ provides unrivalled helm response and minimum weight. It can be easily customised by cutting to length and re-fitting the universal joint.

- KEY POINTS**
- ▶ Lightweight, rigid construction
  - ▶ Secure, comfortable grip
  - ▶ Quick fitting universal joint for accurate helm response

PRODUCT No.	DESCRIPTION	TUBE DIAM.		GRIP DIAM.		LENGTH		WEIGHT	
		mm	(in.)	mm	(in.)	mm	(in.)	g	(oz)
RF3107	Carbon-Fibre	16	(5/8")	25	(1")	1220	(48)	133	(4.7)
RF3122	Lightweight	16	(5/8")	25	(1")	2030	(80)	415	(14.7)
RF3128	Lightweight	16	(5/8")	25	(1")	610	(24)	150	(5.3)
RF3129	Lightweight	16	(5/8")	25	(1")	840	(33)	180	(6.4)
RF3130	Lightweight	16	(5/8")	25	(1")	1030	(41)	215	(7.6)
RF3135	Lightweight	16	(5/8")	25	(1")	1200	(47)	245	(8.7)
RF3137	Lightweight	16	(5/8")	25	(1")	2500	(98)	515	(18.2)
RF3119	Jumbo	25	(1")	38 (1 1/2")		810	(32)	265	(9.4)
RF3120	Jumbo	25	(1")	38 (1 1/2")		920	(36)	275	(9.7)
RF3121	Jumbo	25	(1")	38 (1 1/2")		1170	(46)	355	(12.5)
RF3138	Jumbo Cut-to-length	25	(1")	38 (1 1/2")		up to 2500	(up to 98)	690	(24.3)
RF3124	Telescopic	16+20	(5/8+3/4")	30 (1 1/4")		1530-2490	(60-98)	485	(17.1)
RF3131	Telescopic	16+20	(5/8+3/4")	30 (1 1/4")		740-1210	(29-48)	285	(10.1)
RF3132	Telescopic	16+20	(5/8+3/4")	30 (1 1/4")		1070-1770	(42-70)	400	(14.1)
RF3134	Telescopic, Split Grip	16+20	(5/8+3/4")	30 (1 1/4")		740-1120	(29-44)	310	(10.9)
RF3116	Ladder	16	(5/8")	22 (7/8")		660	(26)	400	(14.4)
RF3117	Ladder	16	(5/8")	22 (7/8")		914	(36)	450	(15.9)
RF3118	Ladder, Stainless Steel bolt-through universal joint	16	(5/8")	22 (7/8")		914	(36)	500	(17.6)



RF1135-16



RF1135-20



RF1135-25



RF3133



RF3136



RF3139



RF1127



RF1121

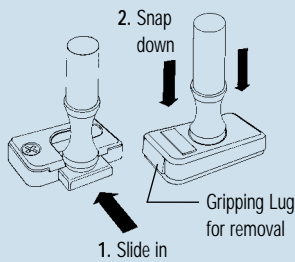

RF3133 SNAP ON/OFF FEATURE

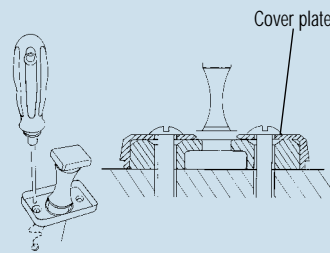

RF3133 PERMANENT MOUNT

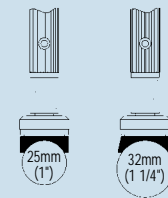

RF3136 SUITS 25-32mm (1-1 1/4") DIAM. TILLERS

The RF3133 urethane universal joint permits smooth movement in all directions for precise control and instant helm response with no play in the joint.

The rectangular flange on the joint slides into the base, which remains fixed to the tiller. A snap-on cover plate secures the assembly but allows the tiller extension

to be removed from the boat for security. Permanent installation can be achieved by fastening through the cover plate and the base as shown.

PRODUCT No.	DESCRIPTION	WEIGHT	
		g	(oz)
RF1121	Stainless Steel bolt-through universal joint. Suits 16mm (5/8") dia. tube Incorporating 1/4" U.N.C.x1 3/4" (45mm) long bolt	55	(1.9)
RF1127	Stainless Steel screw down universal joint. Suits 16mm (5/8") dia. tube	50	(1.8)
RF1135-16	Nylon Tiller extension retaining clip. Suits 16mm (5/8") dia. tube	7	(0.2)
RF1135-20	Nylon Tiller extension retaining clip. Suits 20mm (3/4") dia. tube	4	(0.1)
RF1135-25	Nylon Tiller extension retaining clip. Suits 25mm (1") dia. tube	4	(0.1)
RF3133	Urethane universal joint. Suits 13.5mm (17/32") I.D. tube	35	(1.2)
RF3136	Round tiller adapter for RF3133, suits 25-32mm (1-1 1/4") tiller	7	(0.2)
RF3139	Heat shrink tube, suits 16mm (5/8") dia. tube	-	-