

Rigging products for swaging have product numbers that are coded to indicate certain dimensions of the product. The first four digits identify the product type. The first two digits of the suffix identify the wire diameter, and the last two digits denote the thread size expressed in 1/16".

Example
RF1579 M1010.
RF1579 identifies the product as a metric Seafast Rigging Screw.
M10 = Metric 10mm wire.
10 = 10/16" or 5/8" thread.

For imperial product the first two digits of the suffix identify the wire size expressed as in 1/32". The last two digits denote the thread size expressed as 1/16".

Example
RF1577-0908.
RF1577 identifies the product as an imperial Seafast rigging screw.
09 = Imperial 9/32" wire.
08 = 8/16" or 1/2" thread.

REPLACEMENT R/H LOCK NUT Product No.	THREAD U.N.F. in.	REPLACEMENT L/H LOCK NUT Product No.
RF1516-03	3/16	RF1517-03
RF1516-04	1/4	RF1517-04
RF1516-05	5/16	RF1517-05
RF1516-06	3/8	RF1517-06
RF1516-08	1/2	RF1517-08
RF1516-10	5/8	RF1517-10
RF1516-12	3/4	RF1517-12
RF1516-14	7/8	RF1517-14
RF1516-16	1	RF1517-16
RF1516-20	1 1/4	RF1517-20
RF1516-22	1 3/8	RF1517-22

WIRE DIAM.	PRODUCT No.	THREAD U.N.F. in.	D & J mm (in.)	R mm (in.)	S mm (in.)	L MIN mm (in.)	L MAX mm (in.)	BL kg (lb)	WEIGHT g (oz)
Toggle - Metric Swage									
2.5mm	RF1579M2.503 *	3/16	4.8 (3/16)	6.4 (1/4)	11.1 (7/16)	135 (3 3/8)	188 (7 3/8)	890 (1960)	44 (1.6)
3mm	RF1579M0304	1/4	6.4 (1/4)	9.5 (3/8)	16.1 (5/8)	184 (7 1/4)	257 (10 1/8)	1630 (3590)	97 (3.4)
4mm	RF1579M0404	1/4	6.4 (1/4)	9.5 (3/8)	16.1 (5/8)	198 (7 13/16)	271 (10 11/16)	1630 (3590)	102 (3.6)
4mm	RF1579M0405	5/16	7.9 (5/16)	11.1 (7/16)	20.6 (13/16)	204 (8)	272 (10 3/4)	2250 (4950)	177 (6.2)
5mm	RF1579M0505	5/16	7.9 (5/16)	11.1 (7/16)	20.6 (13/16)	221 (8 11/16)	285 (11 1/4)	2250 (4950)	188 (6.6)
5mm	RF1579M0506	3/8	9.5 (3/8)	14.4 (9/16)	22.5 (7/8)	237 (9 3/8)	307 (12 1/8)	3350 (7370)	287 (10.1)
6mm	RF1579M0608	1/2	12.7 (1/2)	17.5 (11/16)	28 (1 1/8)	316 (12 7/16)	396 (15 5/8)	5430 (11950)	685 (24.2)
7mm	RF1579M0708	1/2	12.7 (1/2)	17.5 (11/16)	28 (1 1/8)	324 (12 3/4)	404 (15 7/8)	5430 (11950)	710 (25.0)
8mm	RF1579M0808	1/2	12.7 (1/2)	17.5 (11/16)	28 (1 1/8)	341 (13 7/16)	421 (16 5/8)	5430 (11950)	740 (26.1)
10mm	RF1579M1010	5/8	15.9 (5/8)	21 (13/16)	41 (1 5/8)	426 (16 3/4)	536 (21 1/8)	8700 (19140)	1320 (46.6)
12mm	RF1579M1212	3/4	19 (3/4)	24 (15/16)	45 (1 3/4)	467 (18 3/8)	577 (22 3/4)	12650 (27830)	2060 (72.7)
14mm	RF1579M1414	7/8	22.2 (7/8)	29 (1 1/8)	45 (1 3/4)	539 (21 1/4)	664 (26 1/8)	17250 (37950)	3050 (107.6)
16mm	RF1579M1616	1	25.4 (1)	30 (1 3/16)	59 (2 5/16)	622 (24 1/2)	752 (29 5/8)	22510 (49520)	5400 (190.5)
19mm	RF1579M1920	1 1/4	31.8 (1 1/4)	42 (1 11/16)	74 (2 15/16)	762 (30)	882 (34 3/4)	36330 (79929)	11180 (394.3)
22mm	RF1579M2220	1 1/4	31.8 (1 1/4)	42 (1 11/16)	74 (2 15/16)	791 (31 1/8)	911 (35 7/8)	36330 (79929)	11710 (413.0)
26mm	RF1579M2622	1 3/8	34.9 (1 3/8)	47 (1 7/8)	75 (2 31/32)	977 (38 1/2)	1267 (49 7/8)	43500 (95700)	19110 (674.0)
Toggle - Imperial Swage									
1/4 in.	RF1577-0808	1/2	12.7 (1/2)	17.5 (11/16)	28 (1 1/8)	316 (12 7/16)	396 (15 5/8)	5430 (11950)	685 (24.2)
9/32 in.	RF1577-0908	1/2	12.7 (1/2)	17.5 (11/16)	28 (1 1/8)	323 (12 3/4)	403 (15 7/8)	5430 (11950)	710 (25.0)
5/16 in.	RF1577-1008	1/2	12.7 (1/2)	17.5 (11/16)	28 (1 1/8)	341 (13 7/16)	421 (16 5/8)	5430 (11950)	740 (26.1)
3/8 in.	RF1577-1210	5/8	15.9 (5/8)	21 (13/16)	41 (1 5/8)	420 (16 1/2)	530 (20 7/8)	8700 (19140)	1330 (46.9)
7/16 in.	RF1577-1412	3/4	19 (3/4)	24 (15/16)	45 (1 3/4)	460 (18 1/8)	570 (22 7/16)	12650 (27830)	2040 (72.0)
1/2 in.	RF1577-1614	7/8	22.2 (7/8)	29 (1 1/8)	45 (1 3/4)	530 (20 7/8)	655 (25 3/4)	17250 (37950)	3020 (106.0)
9/16 in.	RF1577-1816	1	22.2 (7/8)	29 (1 1/8)	45 (1 3/4)	599 (23 5/8)	729 (28 3/4)	22510 (49520)	5240 (184.8)
5/8 in.	RF1577-2016	1	25.4 (1)	30 (1 3/16)	59 (2 5/16)	625 (24 5/8)	755 (29 3/4)	22510 (49520)	5410 (190.8)
3/4 in.	RF1577-2420	1 1/4	31.8 (1 1/4)	42 (1 11/16)	74 (2 15/16)	770 (30 5/16)	890 (35)	36330 (79929)	11230 (396.1)
7/8 in.	RF1577-2820	1 1/4	31.8 (1 1/4)	42 (1 11/16)	74 (2 15/16)	810 (31 7/8)	930 (36 5/8)	36330 (79929)	11830 (417.2)
1 in.	RF1577-3222	1 3/8	34.9 (1 3/8)	47 (1 7/8)	75 (2 31/32)	986 (38 7/8)	1276 (50 1/4)	43500 (95700)	19200 (677.2)

* RF1579M2.503 has a Fork end, not Toggle

TOGGLE



TOGGLE

TOGGLE



EYE

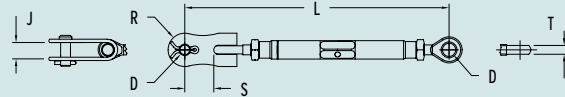
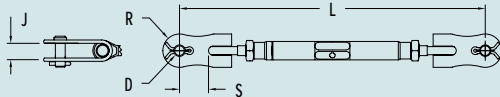

MATERIALS

- ▶ Chrome plated Brass bodies
- ▶ Grade 316 Stainless Steel toggles
- ▶ Grade 316 Stainless Steel terminals
- ▶ Chrome plated Brass and SMH Brass locking nuts

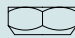
	REPLACEMENT R/H LOCK NUT Product No.	THREAD U.N.F. in.	REPLACEMENT L/H LOCK NUT Product No.
	RF1516-04	1/4	RF1517-04
	RF1516-05	5/16	RF1517-05
	RF1516-06	3/8	RF1517-06
	RF1516-08	1/2	RF1517-08
	RF1516-10	5/8	RF1517-10
	RF1516-12	3/4	RF1517-12
	RF1516-14	7/8	RF1517-14
	RF1516-16	1	RF1517-16
	RF1516-20	1 1/4	RF1517-20
	RF1516-22	1 3/8	RF1517-22

WIRE DIAM. mm	PRODUCT (in.) No.	THREAD U.N.F. in.	D & J mm (in.)	R mm (in.)	S mm (in.)	T mm (in.)	L MIN mm (in.)	L MAX mm (in.)	BL kg (lb)	WEIGHT g (oz)
Toggle-Toggle										
3	(1/8) RF506	1/4	6.4 (1/4)	9 (3/8)	15 (9/16)	-	165 (6 1/2)	220 (8 11/16)	1630 (3590)	120 (4.2)
4-5	(5/32-3/16) RF508	5/16	7.9 (5/16)	11 (7/16)	20 (13/16)	-	187 (7 3/8)	245 (9 5/8)	2250 (4950)	220 (7.8)
5-6	(3/16-7/32) RF510	3/8	9.5 (3/8)	14.5 (9/16)	22 (7/8)	-	210 (8 1/4)	270 (10 5/8)	3350 (7370)	360 (12.7)
6-8	(7/32-5/16) RF1591	1/2	12.7 (1/2)	17.5 (11/16)	28 (1 1/8)	-	285 (11 1/4)	365 (14 3/8)	5430 (11950)	850 (30.0)
8-10	(5/16-3/8) RF1592	5/8	15.9 (5/8)	30 (1 3/16)	41 (1 5/8)	-	370 (14 9/16)	480 (18 15/16)	8700 (19140)	1510 (53.3)
10-12	(3/8-7/16) RF1593	3/4	19 (3/4)	33 (1 5/16)	45 (1 3/4)	-	405 (15 15/16)	510 (20 1/8)	12650 (27830)	2480 (87.5)
13-14	(1/2-9/16) RF1594	7/8	22.2 (7/8)	29 (1 1/8)	45 (1 3/4)	-	470 (18 1/2)	590 (23 1/4)	17250 (37950)	3725 (131.0)
16-18	(5/8-3/4) RF1595	1	25.4 (1)	30 (1 3/16)	59 (2 5/16)	-	552 (21 3/4)	672 (26 1/2)	22510 (49522)	6610 (233.0)
20-22	(3/4-7/8) RF1596	1 1/4	32 (1 1/4)	42 (1 11/16)	74 (2 15/16)	-	680 (26 13/16)	800 (31 1/2)	36330 (79926)	13510 (477.0)
24-26	(1) RF1597	1 3/8	34.9 (1 3/8)	47 (1 7/8)	75 (2 31/32)	-	818 (32 7/32)	1175 (46 1/4)	43500 (95700)	22040 (777.0)
Toggle-Eye										
3	(3/32) RF505	1/4	6.4 (1/4)	9 (3/8)	15 (9/16)	4.6 (3/16)	142 (5 5/8)	198 (7 13/16)	1630 (3590)	90 (3.2)
4-5	(5/32-3/16) RF507	5/16	7.9 (5/16)	11 (7/16)	20 (13/16)	6.1 (1/4)	160 (6 5/16)	210 (8 1/4)	2250 (4950)	170 (6.0)
5-6	(3/16-7/32) RF509	3/8	9.5 (3/8)	14.5 (9/16)	22 (7/8)	7.9 (5/16)	178 (7)	238 (9 3/8)	3350 (7370)	270 (9.5)

Note – Toggle/Eye Turnbuckles are available in larger sizes (up to 1 3/8" thread). Details on request.

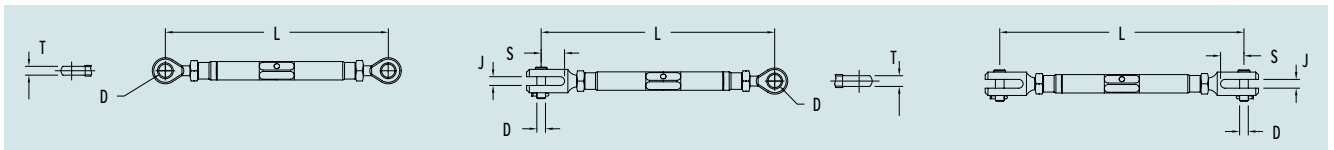

Seafast turnbuckles are traditional closed body turnbuckles with polished Chrome plated, high grade Brass bodies and Grade 316 Stainless Steel end fittings. This combination of materials avoids the risk of excessive thread wear or seizure under load that can occur in turnbuckles with all-Stainless Steel components.

After tensioning, internally tapered locking nuts secure the adjustment. Sight holes are provided in the bodies to verify adequate thread engagement.

For easy thread identification, a machined groove identifies the left-hand thread locking nut and body end.

	REPLACEMENT R/H LOCK NUT Product No.	THREAD U.N.F. in.	REPLACEMENT L/H LOCK NUT Product No.
	RF1516-03	3/16	RF1517-03
	RF1516-04	1/4	RF1517-04
	RF1516-05	5/16	RF1517-05
	RF1516-06	3/8	RF1517-06
	RF1516-08	1/2	RF1517-08
	RF1516-10	5/8	RF1517-10
	RF1516-12	3/4	RF1517-12
	RF1516-14	7/8	RF1517-14
	RF1516-16	1	RF1517-16
	RF1516-20	1 1/4	RF1517-20
	RF1516-22	1 3/8	RF1517-22

WIRE DIAM.	PRODUCT	THREAD	D	T	J	S	L MIN	L MAX	BL	WEIGHT
mm (in.)	No.	U.N.F. in.	mm (in.)	mm (in.)	mm (in.)	mm (in.)	mm (in.)	mm (in.)	kg (lb)	g (oz)
Eye-Eye										
2	(3/32)	RF217	3/16	4.8 (3/16)	4.1 (5/32)	-	89 (3 1/2)	127 (5)	890 (1960)	40 (1.4)
3	(1/8)	RF220	1/4	6.4 (1/4)	4.5 (3/16)	-	121 (4 3/4)	178 (7)	1630 (3590)	95 (3.3)
4-5	(5/32-3/16)	RF223	5/16	7.9 (5/16)	6.3 (1/4)	-	124 (4 7/8)	179 (7 1/16)	2250 (4950)	125 (4.4)
5-6	(3/16-7/32)	RF226	3/8	9.5 (3/8)	8 (5/16)	-	146 (5 3/4)	208 (8 3/16)	3350 (7370)	170 (6.0)
6-8	(1/4-5/16)	RF1548	1/2	12.7 (1/2)	12.7 (1/2)	-	202 (7 15/16)	283 (11 1/8)	5430 (11950)	590 (20.8)
8-10	(5/16-3/8)	RF1549	5/8	15.9 (5/8)	14.3 (9/16)	-	260 (10 1/4)	365 (14 7/16)	8700 (19140)	935 (33.0)
10-12	(3/8-7/16)	RF1550	3/4	19 (3/4)	15.9 (5/8)	-	280 (11)	390 (15 7/16)	12650 (27830)	1445 (51.0)
13-14	(1/2-9/16)	RF1551	7/8	22.2 (7/8)	22 (7/8)	-	335 (13 3/16)	455 (17 15/16)	17250 (37950)	2110 (74.5)
16-18	(5/8-11/16)	RF1552	1	25.4 (1)	25.5 (1)	-	372 (14 11/16)	492 (19 3/8)	22510 (49522)	3560 (125.6)
20-22	(13/16-7/8)	RF1553	1 1/4	31.7 (1 1/4)	29 (1 1/8)	-	460 (18 1/8)	580 (22 7/8)	36330 (79226)	7800 (275.0)
24-26	(1)	RF1554	1 3/8	34.9 (1 3/8)	33 (1 5/16)	-	598 (23 9/16)	955 (37 5/8)	43500 (95700)	12240 (432.0)
Fork-Eye										
2	(3/32)	RF218	3/16	4.8 (3/16)	4 (5/32)	4.8 (3/16)	99 (3 7/8)	137 (5 3/8)	890 (1960)	50 (1.7)
3	(1/8)	RF221	1/4	*6.4 (1/4)	4.6 (3/16)	4.8 (3/16)	126 (4 15/16)	183 (7 3/16)	1630 (3590)	100 (3.5)
4-5	(5/32-3/16)	RF224	5/16	**6.4 (1/4)	6.1 (1/4)	6.4 (1/4)	136 (5 7/16)	191 (7 1/2)	2250 (4950)	145 (5.1)
5-6	(3/16-7/32)	RF227	3/8	**9.5 (3/8)	7.7 (5/16)	6.4 (1/4)	162 (6 3/8)	223 (8 13/16)	3350 (7370)	240 (8.5)
Fork-Fork										
2	(3/32)	RF219	1/8	4.8 (3/16)	-	4.8 (3/16)	109 (4 5/16)	147 (5 13/16)	890 (1960)	60 (2.1)
3	(1/8)	RF222	1/4	4.8 (3/16)	-	4.8 (3/16)	132 (5 13/16)	189 (7 7/16)	1630 (3590)	115 (4.0)
4-5	(5/32-3/16)	RF225	5/16	6.4 (1/4)	-	6.4 (1/4)	148 (5 13/16)	203 (8)	2250 (4950)	170 (6.0)
5-6	(3/16-7/32)	RF228	3/8	9.5 (3/8)	-	6.4 (1/4)	179 (7 1/16)	241 (9 1/2)	3350 (7370)	300 (10.5)

* Fork D = 4.8mm (3/16") ** Fork D = 7.9mm (5/16")

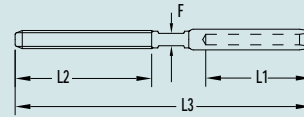

Seafast threaded swage terminals have a shorter thread to suit Ronstan 'Seafast' turnbuckles. Threaded swage terminals have rolled R/H UNF threads for greater

strength and are manufactured from Grade 316 Stainless Steel for maximum corrosion resistance.

WIRE DIAMETER

- ▶ Imperial: 3/32" – 1"
- ▶ Metric: 2.5mm – 26mm

WIRE DIAM.	PRODUCT No.	SUIT TURNBUCKLE	THREAD U.N.F. in.	F mm (in.)	L1 mm (in.)	L2 mm (in.)	L3 mm (in.)	WEIGHT g (oz)
Metric Swage								
2.5mm	RF1513M2.503	RF217,218,219	3/16	4 (5/32)	30 (1 3/16)	32 (1 1/4)	78 (3 1/8)	10 (0.4)
3mm	RF1513M0304	RF220,222,505,506	1/4	4 (5/32)	38 (1 1/2)	48 (1 7/8)	101 (4)	19 (0.7)
4mm	RF1513M0404	RF220,222,505,506	1/4	4 (5/32)	46 (1 13/16)	48 (1 7/8)	115 (4 1/2)	24 (0.8)
4mm	RF1513M0405	RF223,224,225,507,508	5/16	6.3 (1/4)	46 (1 13/16)	46 (1 13/16)	110 (4 5/16)	31 (1.1)
5mm	RF1513M0504	RF220,222,505,506	1/4	4 (5/32)	56 (2 3/16)	48 (1 7/8)	126 (5)	35 (1.2)
5mm	RF1513M0505	RF223, 224, 225, 507, 508	5/16	5.3 (7/32)	56 (2 3/16)	46 (1 13/16)	124 (4 7/8)	42 (1.5)
5mm	RF1513M0506	RF226,227,228,509,510	3/8	6.3 (1/4)	55 (2 1/8)	51 (2)	122 (4 13/16)	49 (1.7)
6mm	RF1513M0608	RF1579M0608	1/2	8.5 (11/32)	70 (2 3/4)	70 (2 3/4)	173 (6 13/16)	135 (4.8)
7mm	RF1513M0708	RF1579M0708	1/2	8.5 (11/32)	79 (3 1/8)	70 (2 3/4)	186 (7 5/16)	168 (5.9)
8mm	RF1513M0808	RF1579M0808	1/2	8.5 (11/32)	88 (3 1/2)	70 (2 3/4)	198 (7 13/16)	200 (7.1)
10mm	RF1513M1010	RF1579 M1010	5/8	11.5 (7/16)	110 (4 5/16)	96 (3 3/4)	241 (9 1/2)	320 (11.3)
12mm	RF1513M1212	RF1579M1212	3/4	14.5 (9/16)	140 (5 1/2)	118 (4 5/8)	304 (12)	680 (24.0)
14mm	RF1513M1414	RF1579M1414	7/8	18 (23/32)	158 (6 1/4)	130 (5 1/8)	341 (13 3/8)	1040 (36.7)
16mm	RF1513M1616	RF1579M1616	1	18 (23/32)	177 (7)	130 (5 1/8)	352 (13 7/8)	1200 (42.3)
19mm	RF1513M1920	RF1579M1920	1 1/4	25.5 (1)	211 (8 5/16)	150 (5 15/16)	421 (16 9/16)	2270 (80.1)
22mm	RF1513M2220	RF1579M2220	1 1/4	25.5 (1)	226 (8 7/8)	150 (5 15/16)	443 (17 7/16)	2600 (91.7)
26mm	RF1513M2622	RF1579M2622	1 3/8	29.5 (1 5/32)	272 (10 3/4)	236 (9 5/16)	588 (23 3/16)	4680 (165.1)
Imperial Swage								
3/32 in.	RF1511-0303	RF217,218,219	3/16	4 (5/32)	30 (1 3/16)	32 (1 1/4)	78 (3 1/8)	10 (0.4)
1/8 in.	RF1511-0404	RF220,222,505,506	1/4	4.5 (3/16)	38 (1 1/2)	48 (1 7/8)	101 (4)	19 (0.7)
5/32 in.	RF1511-0505	RF223,224,225,507,508	5/16	6.3 (1/4)	45 (1 13/16)	46 (1 13/16)	110 (4 5/16)	31 (1.1)
3/16 in.	RF1511-0606	RF226,227,228,509,510	3/8	6.3 (1/4)	55 (2 1/8)	51 (2)	122 (4 13/16)	49 (1.7)
7/32 in.	RF1511-0706	RF226,227,228,509,510	3/8	6.3 (1/4)	60 (2 3/8)	51 (2)	137 (5 3/8)	66 (2.3)
1/4 in.	RF1511-0808	RF1577-0808	1/2	8.5 (11/32)	70 (2 3/4)	70 (2 3/4)	173 (6 13/16)	135 (4.8)
9/32 in.	RF1511-0908	RF1577-0908	1/2	8.5 (11/32)	78 (3 1/8)	70 (2 3/4)	185 (7 5/16)	168 (5.9)
5/16 in.	RF1511-1008	RF1577-1008	1/2	8.5 (11/32)	88 (3 1/2)	70 (2 3/4)	198 (7 13/16)	200 (7.1)
3/8 in.	RF1511-1210	RF1577-1210	5/8	11.5 (7/16)	109 (4 5/16)	96 (3 3/4)	236 (9 1/4)	320 (11.3)
7/16 in.	RF1511-1412	FR1577-1412	3/4	12 (15/32)	122 (4 13/16)	105 (4 1/8)	262 (10 5/16)	460 (16.2)
1/2 in.	RF1511-1614	RF1577-1614	7/8	14.5 (9/16)	140 (5 1/2)	118 (4 5/8)	297 (11 11/16)	670 (23.6)
9/16 in.	RF1511-1816	RF1577-1816	1	18 (23/32)	157 (6 3/16)	130 (5 1/8)	341 (13 3/8)	1040 (36.7)
5/8 in.	RF1511-2016	RF1577-2016	1	18 (23/32)	176 (6 15/16)	130 (5 1/8)	355 (14)	1210 (42.7)
3/4 in.	RF1511-2420	RF1577-2420	1 1/4	25.5 (1)	219 (8 5/8)	150 (5 15/16)	429 (16 7/8)	2320 (81.8)
7/8 in.	RF1511-2820	RF1577-2820	1 1/4	25.5 (1)	245 (9 5/8)	150 (5 15/16)	462 (18 3/16)	2720 (95.9)
1 in.	RF1511-3222	RF1577-3220	1 3/8	29.5 (1 5/32)	281 (11 1/16)	236 (9 5/16)	597 (23 1/2)	4770 (168.2)

Swage terminals have RH U.N.F. thread.